

Radio frequency signal penetration through various construction materials /

Prestup rádiových signálov rôznymi stavebnými materiálmi

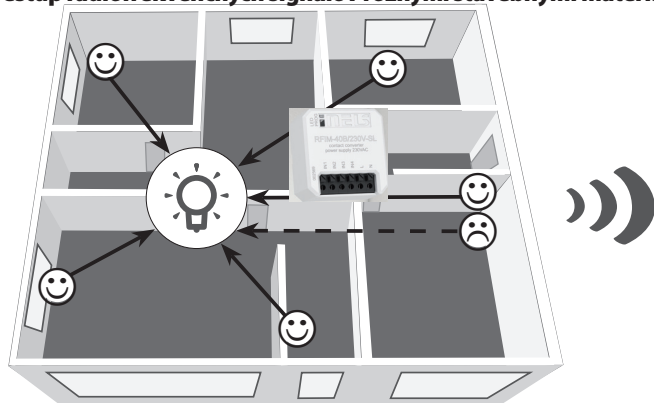

	60 - 90 %	80 - 95 %	20 - 60 %	0 - 10 %	80 - 90 %
	brick walls	wooden structures with plaster boards	reinforced concrete	metal partitions	common glass
	tehlové steny	drevené konštrukcie so sádkokart. doskami	vystužený betón	kovové prepážky	bežné sklo

Technical parameters / Technické parametre

		RFIM-40B/BP-SL	RFIM-40B/230-SL
Supply voltage:	Napájacie napätie:	1 x 3V battery / baterie CR 123A	230V AC
Battery life:	Životnosť batérie:	8 years / rokov podľa frekvencie používania*	
Transmission indication / function:	Indikácia prenosu / funkcie:	red / červená LED	
Number of inputs:	Počet vstupov:	4	4
Supply voltage tolerance:	Tolerancia napájacieho napätia:		+10%; -15%
Control / Ovládání			
Communication protocol:	Komunikačný protokol:	RFIO2	
Frequency:	Frekvencia:	866-922 MHz (viac na strane 74)	
Repeater function:	Funkcia repeater:	ne	
Signal transmission method:	Spôsob prenosu signálu:	one-way addressed message / jednosmerne adresovaná správa	
Reach:	Dosah na voľnom priestranstve:	in the open up to 200 m / na voľnom priestranstve až 200 m	
Other data / Ďalšie údaje			
Operating temperature:	Pracovná teplota:	-10 až +50 °C	
Operating position:	Pracovná poloha:	any/libovolná	
Resist.of connection between terminals	Odpor vedenia medzi svorkami		
- for switched on button:	- pre zopnuté tlačítko:	< 300 Ω	
- for disconnected contact:	- pre rozopnutý kontakt:	> 10 kΩ	
Mounting:	Upevnenie:	free at lead-in wires / voľné na prívodných vodičoch	
Protection:	Krytie:	IP40	
Voltage category:	Kategória napätia:	III.	
Contamination degree:	Stupeň znečistenia:	2	
Connection	Pripojenie:	screwless terminals / bezskrútkové svorky	
Dimensions:	Rozmery:	43 x 44 x 22 mm	
Cross section of connecting wires (mm²)	Prierez pripojovacích vodičov (mm²):	0.2-1.5 mm² solid/flexible	
Weight:	Hmotnosť:	37 g	25 g
Contact voltage:	Napätie otvoreného kontaktu:	3 V	230 V
Length of cable to contact:	Dĺžka káblu ku kontaktu:	max. 5 m	max. 100 m
		parallel line / súbežného vedenia	
Related standards:	Súvisiace normy:	EN 60730, EN 63044, EN 300 220, EN 301 489	

* RFIM-40B - on condition, that contact is permanently closed- battery life is approx. 1 year.

Attention:

When you instal iNELS RF Control system, you have to keep minimal distance 1 cm between each units.

Between the individual commands must be an interval of at least 1s.

* RFIM-40B/BP-SL pri trvalo zopnutých všetkých kontaktoch je životnosť batérie cca 1 rok.

Upozornenie:

Pri inštalácii systému iNELS RF Control musí byť dodržaná minimálna vzdialenosť medzi jednotlivými prvkami 1 cm.

Medzi jednotlivými povelmi musí byť rozostup minimálne 1s.

Insertion and replacement of a battery / Vloženie a výmena batérie

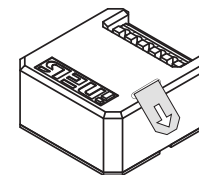

Batteries is inserted in the product. Before using for the first time, remove the insulating tape from the battery contacts by pulling in the direction of the arrow.

Batérie je vložena vo výrobku. Pred prvým použitím ťahom v smere šípky odstráňte izolačnú pásku kontaktov batérie.

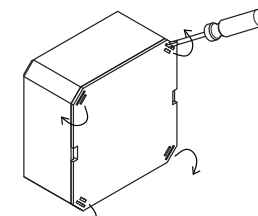

Using a screwdriver and a light lever in the groove outwards, unlock the four sides of the snap.

Pomocou skrutkovača a ľahkým zapáčením v drážke smerom von odistite na styroch stranách zácvaky.

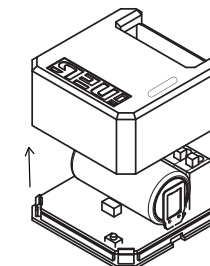

Remove the top cover of the product. Odoberte horný kryt výrobku.

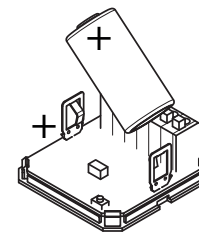

Remove the old battery and dispose of it in an environmentally friendly manner.

Vyberte starú batériu a odovzdajte na ekologickú likvidáciu.

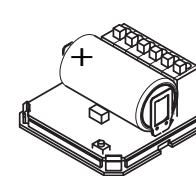

Insert a new battery, paying attention to the polarity of the battery.

Vložte batériu novú, dávajte pozor na polaritu batérie.

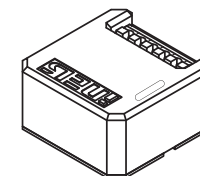

Replace the cover, pushing the tabs in the corners.

Nasaďte späť kryt, dotlačte zácvaky v rohoch.

Warning

Instruction manual is designated for mounting and also for user of the device. It is always a part of its packing. Installation and connection can be carried out only by a person with adequate professional qualification upon understanding this instruction manual and functions of the device, and while observing all valid regulations. Trouble-free function of the device also depends on transportation, storing and handling. In case you notice any sign of damage, deformation, malfunction or missing part, do not install this device and return it to its seller. It is necessary to treat this product and its parts as electronic waste after its lifetime is terminated. Before starting installation, make sure that all wires, connected parts or terminals are de-energized. While mounting and servicing observe safety regulations, norms, directives and professional, and export regulations for working with electrical devices. Do not touch parts of the device that are energized – life threat. Due to transmissivity of RF signal, observe correct location of RF components in a building where the installation is taking place. RF Control is designated only for mounting in interiors. Devices are not designated for installation into exteriors and humid spaces. The must not be installed into metal switchboards and into plastic switchboards with metal door – transmissivity of RF signal is then impossible. RF Control is not recommended for pulleys etc. – radiofrequency signal can be shielded by an obstruction, interfered, battery of the transceiver can get flat etc. and thus disable remote control.

ELKO EP declares that the RFIM-40B-SL type of equipment complies with Directives 2014/30/EU, 2011/65/EU, 2015/863/EU and 2014/35/EU. The full EU Declaration of Conformity is available at:
<https://www.elkoep.com/wireless-contact-converter-rfim-20b>
<https://www.elkoep.com/wireless-contact-converter-rfim-40b>

ELKO EP, s.r.o., Palackého 493, 769 01 Holešov, Vsetuly, Czech Republic
 Tel.: +420 573 514 211, e-mail: elko@elkoep.com, www.elkoep.com

Varovanie

Instruction manual is designated for mounting and also for user of the device. It is always a part of its packing. Installation and connection can be carried out only by a person with adequate professional qualification upon understanding this instruction manual and functions of the device, and while observing all valid regulations. Trouble-free function of the device also depends on transportation, storing and handling. In case you notice any sign of damage, deformation, malfunction or missing part, do not install this device and return it to its seller. It is necessary to treat this product and its parts as electronic waste after its lifetime is terminated. Before starting installation, make sure that all wires, connected parts or terminals are de-energized. While mounting and servicing observe safety regulations, norms, directives and professional, and export regulations for working with electrical devices. Do not touch parts of the device that are energized – life threat. Due to transmissivity of RF signal, observe correct location of RF components in a building where the installation is taking place. RF Control is designated only for mounting in interiors. Devices are not designated for installation into exteriors and humid spaces. The must not be installed into metal switchboards and into plastic switchboards with metal door – transmissivity of RF signal is then impossible. RF Control is not recommended for pulleys etc. – radiofrequency signal can be shielded by an obstruction, interfered, battery of the transceiver can get flat etc. and thus disable remote control.

Týmto ELKO EP, s.r.o. prehlasuje, že typ rádiového zariadenia RFIM-40B-SL je v súlade so smernicou 2014/30/EU, 2011/65/EU, 2015/863/EU a 2014/35/EU. Úplné znenie EU prehlásenia o zhode je k dispozícii na týchto internetových stránkach:
<https://www.elkoep.sk/bezdrotovy-prevodnik-kontaktu-rfim-20b>
<https://www.elkoep.sk/bezdrotovy-prevodnik-kontaktu-4-vstupy-rfim-40b>

ELKO EP SLOVAKIA, s.r.o., Fraňa Mojtu 18, 949 01 Nitra, Slovenská republika
 Tel.: +421 37 6586 731, e-mail: elkoep@elkoep.sk, www.elkoep.sk



Made in Czech Republic

ELKO EP, s.r.o. | Palackého 493 | 769 01 | Holešov, Vsetuly | Czech Republic | e-mail: elko@elkoep.com | Support: +420 778 427 366
 ELKO EP SLOVAKIA, s.r.o. | Fraňa Mojtu 18, 949 01 Nitra | Telefón: +421 37 6586 731 | E-mail: elkoep@elkoep.sk

www.elkoep.com